



SIG Arms AG

CH-8212 Neuhausen am Rheinfall
Switzerland

Phone: (052) 674 65 65
Fax: (052) 674 64 18

sig pro is a trademark of SIG Arms AG, Switzerland.

SIG[®], SIGARMS[®], are registered trademarks of SIGARMS Inc.

SIG Arms Inc.

Corporate Park
Industrial Drive
Exeter, NH 03833 USA

Phone: (603) 772-2302
Fax: (603) 772-9082

Internet: www.sigarms.com

OM-20872-USA 8/31/99 Printed in U.S.A.
Images and diagrams copyright SIG Arms Inc. 1999



sig pro[™] **TACTICAL LIGHT** **Handling & Safety** **Instructions**



P/N 20872

SIG Arms, Inc., Corporate Park, Exeter, NH 03833

WARNING

Please read
and understand the
instructions before
using
your flashlight.

Manufacturer:

LASER DEVICES, INC.
2 Harris Court, Suite A-4
Monterey, CA 93940
U.S.A.

Tel: (831) 373-0701

Fax: (831) 373-0903

e-mail: Sales@laserdevices.com

Internet: www.laserdevices.com

Warranty

The **sig pro** tactical light is manufactured by Laser Devices, Inc. USA. Laser Devices, Inc. (LDI) offers a one-year limited warranty from the date of original purchase against failure due to defect in design, parts and workmanship. The warranty does not apply to flashlight bulbs and batteries. The warranty is void if the product serial number has been removed or in the event the product has been misused, modified or neglected. LDI will replace defective products at its discretion. To the maximum extent permitted by law LDI disclaims all other warranties whether expressed or implied, including but not limited to implied warranties of merchantability and fitness for a particular purpose. In no event shall LDI or its suppliers, distributors, dealers or agents be liable for any damages whatsoever (including without limitation damages for personal injury, wrongful death or pecuniary loss) arising out of the use or the inability to use any LDI manufactured product. This limited warranty gives the purchaser specific legal rights, which may vary from state to state or jurisdiction to jurisdiction.

Service & Repair

The **sig pro** tactical light is manufactured to provide years of rugged and dependable use. In the event the light ever needs to be repaired, please contact Laser Devices, Inc. for a return authorization number. Once you obtain the return authorization number, package the product securely and return it postage paid to LDI. In the event the product is not covered by the warranty, you will be notified as to the nature and the cost of the repair.

LASER DEVICES, INC.

2 Harris Court, Suite A-4, Monterey, CA 93940

Safety First

Please read these handling and safety instructions and the instructions for your **sig pro** pistol before attempting to use the tactical light. In addition, please observe all laws in your area relating to the use of firearms. Unload your **sig pro** pistol (remove the magazine and any cartridge in the chamber) prior to mounting the tactical light on your weapon.

Familiarize yourself with the location of the on/off switch for the tactical light.

Make sure the firearm is pointed in a safe direction prior to mounting the tactical light on the weapon.

The Commandments of Firearms Safety

ALWAYS keep the gun pointed in a safe direction.

ALWAYS keep your finger off the trigger until ready to shoot.

ALWAYS keep the gun unloaded until ready to use.

ALWAYS be sure the gun is safe to operate and the barrel is clear of any obstruction.

ALWAYS use proper, factory-made ammunition for your particular gun.

ALWAYS know your target and what is beyond it.

Troubleshooting the Tactical Light (cont'd)

2. Tactical light is weak or dim.
 - A. Replace the batteries (see instructions).
 - B. Check the front lens to make sure that it is not covered with dirt or powder residue. If the front lens is dirty, clean gently with a soft clean cloth taking care not to scratch the lens.
3. If the tactical light still fails to operate, please contact LDI Customer Service for assistance.

Troubleshooting the Tactical Light

In the event the tactical light fails to operate or appears to operate at a low power, please check the following prior to contacting the manufacturer for repair.

1. Fails to operate.
 - A. Replace the batteries (see instructions).
 - B. Check the battery installation to make sure the batteries were properly installed with the positive (+) terminal facing out.
 - C. Replace the flashlight bulb assembly, P/N A02694E, 6 volt.

ALWAYS wear eye and ear protection when shooting.

ALWAYS store guns and ammunition in separate, locked containers so they are secure and not accessible to children or unauthorized persons.

ALWAYS treat every gun as if it were loaded.

NEVER use alcohol or drugs before or during handling of a gun.

NEVER bring a loaded firearm into a building.

NEVER transport a loaded firearm.

Product Description

The **sig pro** tactical light is designed to meet the unique requirements of law enforcement and military professionals. The clip-on design allows the user to decide when to attach the tactical light to the pistol. This exceptional feature allows the pistol to be carried in a security holster without the tactical light attached. When the tactical light is needed the user draws the pistol with one hand while the tactical light is withdrawn from its optional belt pouch with the other hand. The tactical light is then slipped onto the pistol frame directly in front of the trigger guard where it securely locks into place.

Replacement of Flashlight Bulb (cont'd)

Step 3. Using tissue paper or gloves remove the replacement bulb assembly from its packaging. Insert the new bulb into the flashlight head and reassemble the flashlight.

If you inadvertently touch the bulb with bare fingers make sure that you clean it with a soft cotton cloth prior to installation.



Improper bulb handling may result in premature failure of the lamp assembly.

Replacement of Flashlight Bulb

The bulb supplied with your tactical light has an average life expectancy of ten hours depending upon use and handling. **No warranty or guarantee is offered as to the actual life expectancy of the bulb.**

The manufacturer recommends that a spare bulb assembly be available at all times and that bulbs be replaced regularly.

- Step 1. Unscrew the tactical light assembly from the light switch.
- Step 2. Remove the 6 volt bulb assembly P/N A02694E from the flashlight head. See Figure 1.

Tactical Light Specifications*

Light Rating	95 Lumens
Bulb Type	High Pressure Xenon
Battery	2 x Lithium BA-5567-U
Battery Life	45 minutes
Waterproof	to 10m
Material	Aircraft aluminum 6061T-6
Color	Hard black anodized
Length	93.6mm
Head Diameter	32.5mm
Weight	110 grams (including battery)

* Specifications may change without notice.

Figure 1

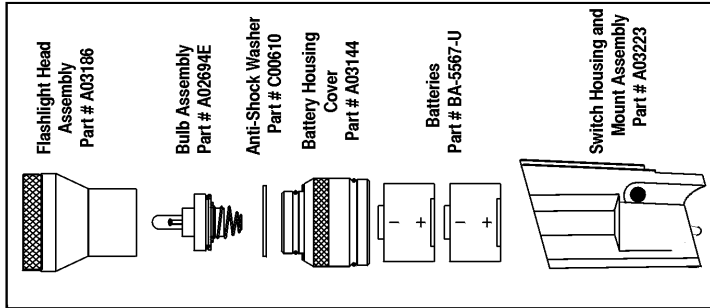

Replacement of Batteries (cont'd)

- Step 3. Remove the tactical light from the pistol (see instructions).
- Step 4. Unscrew the tactical light assembly from the switch assembly.
- Step 5. Remove the batteries.
- Step 6. Reinstall the new batteries as shown in Figure 4.
- Step 7. Reassemble the tactical light to the switch housing.



Replacement of Batteries

The two Lithium BA-5567-U batteries used in the **sig pro** tactical light provide approximately 1 hour of continuous use depending on temperature. This should allow the ordinary user several months of intermittent use. When the tactical light seems too dim, the batteries need to be changed. Follow the steps below to replace the batteries:

- Step 1. Confirm that your **sig pro** pistol is completely unloaded (check the chamber and the magazine).
- Step 2. Make sure that the tactical light is turned off.

Installation of the Tactical Light

Due to minor normal variations in the dimensions of the **sig pro** rail the tactical light may initially be difficult to install and remove from the weapon. Repeated installation and removal of the tactical light will fit it to the rail and make it easier to attach and detach the tactical light. A light coating of gun oil or petroleum jelly may assist in the installation process. You should be advised that the tactical light may leave minor marks on the weapon as part of this process.

- Step 1. Confirm that your **sig pro** pistol is completely unloaded (check the chamber and the magazine).
- Step 2. Remove the tactical light from its package.
- Step 3. Unscrew the tactical light from the switch assembly.

Installation of the Tactical Light (cont'd)

Step 4. Install the two Lithium BA-5567-U (3 volt) batteries with the positive (+) side facing out. See Figure 1.

Step 5. Screw the tactical light head assembly back into the switch assembly and firmly tighten.

Step 6. Activate the tactical light to confirm proper battery installation by flipping one of the two toggle switches into the down position. Turn the unit off. Note: To activate the **sig pro** tactical light either the left or the right switch must always be in the off (up) position.

Removing the Tactical Light (cont'd)

Step 3. Secure the tactical light in its optional belt pouch or replace it in its case. Make sure that you store the **sig pro** tactical light and the pistol in a safe location where they cannot be accessed by children or unauthorized users.

Note: If the tactical light is going to be stored for a long period of time remove the batteries.

Removing the Tactical Light

Step 1. Confirm that your **sig pro** pistol is completely unloaded (check the chamber and the magazine).

Step 2. While holding the pistol in one hand grasp the tactical light in the other hand and fully depress the detach button on the right side of the housing. Slide the tactical light off the pistol.

NOTE: Failure to fully depress the release button while removing the tactical light may result in minor cosmetic damage to the weapon.

Installation of the Tactical Light (cont'd)

Step 7. Pick up your **sig pro** pistol. Grasp the tactical light using your free hand and fully depress the release button and slide it onto the accessory rail located directly in front of the trigger guard until it contacts the trigger guard. Release the button and the tactical light will be securely locked to the trigger guard of the weapon. See Figure 2.

Step 8. Remove the tactical light and repeat Step 7 until it slides easily onto the frame of your pistol. If necessary, lightly lubricate the tactical light to ease the installation and removal of the light.

NOTE: Failure to fully depress the release button while installing or removing the tactical light will result in cosmetic damage to the weapon.

Figure 2



Installation of the Tactical Light (cont'd)

Figure 3

Step 9. Test the function of the tactical light once it is installed on the pistol to familiarize yourself with the operation of the ambidextrous on/off switch. Use the forefinger on your shooting hand to activate the switch. See Figure 3.

